

User Manual

Robot cleaner RYDIS MR6550

Ver 1.0



Please read this manual carefully before using product.



Robot cleaner RYDIS MR6550

Copyright © 2012 MONEUAL Inc. All rights reserved. The MONEUAL, MONCASO, MiNEW, RYDIS, SONAMU are trademarks, or registered trademarks of MONEUAL Inc. in the Republic of Korea and/or other countries.

MONEUAL®

RYDIS MR6550

User Manual

Product features

High-performance BLDC motor

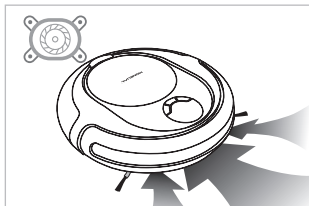

Using the powerful BLDC(suction) motor, the product maximizes the cleaning capability. The BLDC motor has the performance of the 20~30% stronger output than that of DC motor of the same class and also has the lifetime of approximately 5,000 hours that is 10 times longer than that of a typical DC motor.

82mm slim design

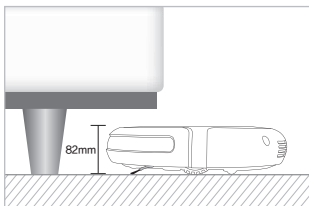

Having a slim design with the height of 82mm, the product can clean the location that a hand cannot reach and is not easy to clean, such as under the bed, under the sofa, etc.

Various cleaning modes

The product provides the most suitable cleaning function and performance for the cleaning environment and save through various cleaning modes.

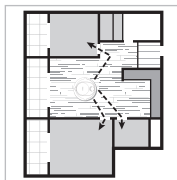

Automatic
cleaning

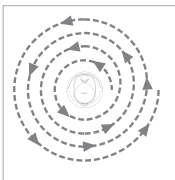

Focused
cleaning

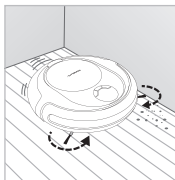

Corner
cleaning

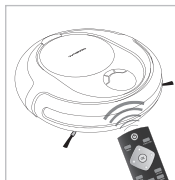

Manual
cleaning

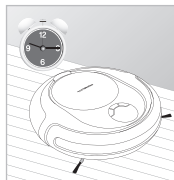

Reservation
cleaning

Shadow cleaning mode

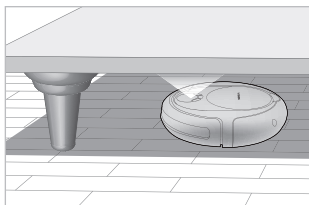

As the function that mainly cleans the dark floor space with no light, Shadow cleaning mode allows the cleaning of the deep locations under a bed or a sofa that were impossible to clean with the existing vacuum cleaners.

Twin side brushes

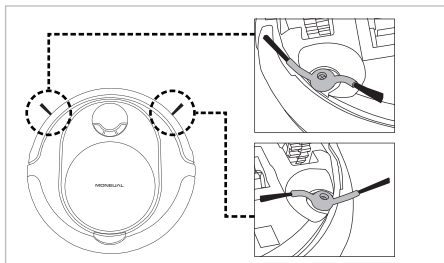

Once being mounted on the left/right of the body of the cleaner, the twin side brushes allow the cleaning of the deep locations that are difficult to clean only with a vacuum suction system

Environment-friendly lithium iron phosphate

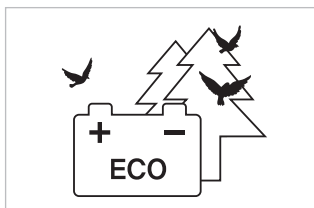

The product uses a environment-friendly battery that does not contain the harmful heavy metals and acids to human body and complies with the environment protection. The lithium iron phosphate battery has the lifetime of approximately three times longer (1,000 times of charging/discharging) than that of the existing lithium-family or nickel-family batteries and provides the high safety because it is strong against high temperature and has almost no risk of explosion.

Room indicator system

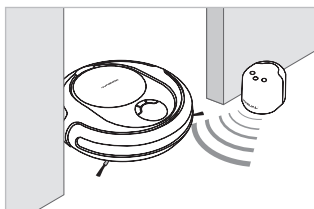

The room indicator allows the user to set various cleaning zones. It has, not only a virtual wall function that blocks the cleaner from entering a space, but also the function to divide the cleaning space into up to three sections for convenient cleaning.

※ Indicator is included in certain models.

Mounting/dismounting microfiber dustcloth cleaning

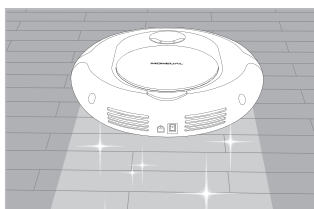

With the mounting/dismounting microfiber dustcloth mounted, the cleaner can remove even fine dusts conveniently.

※ Mopping guard and cloth are included in certain models.

Table of Contents

Cautions for safety	7
Product composition	11
Cautions before using the product	12
Name of each part of the product	13
Robot cleaner	13
Charger	14
Indicator	15
Installing the product	16
Descriptions for remote controller buttons	19
Basic cleaning (Automatic cleaning)	20
Using advanced cleaning functions	21
Focused cleaning	21
Cleaning corners	22
Shadow cleaning	23
Selecting a room for cleaning	24
Mop cleaning	25
Cleaning through manual control	26
Setup of time and reservation	27
Setting reservation	27
Using the indicator	28
Using the product in the room assortment mode	28
Using through setup of cleaning areas	30
Managing the product	32
Language Selection	32
Cleaning the dust box	33
Replacing the filter	34
Cleaning the Sensor	35
Cleaning wheels	35
Cleaning the dust inlet	36
Battery usage and management	38
Voice announcement list	41
System check Code List	42
Checkpoints before request for after-sales service	44
Product specifications	45

Cautions for Safety

The instructions with the following caution marks must be carefully read and followed in order to use the product properly and to prevent accident or damage which may occur during the operation of the product.

Meanings of caution icons



Important

Refers to important information, definitions, general knowledge, and references.



Warning

If you do not follow the instruction with this warning icon, a serious injury or property loss may occur.



Danger

If you do not follow the instruction with this danger icon, a serious injury, death, or property loss may occur.

Before using the product

- **Remove light clothes or fragile materials from the floor.**

It may prevent robot cleaner from moving or cause a trouble.

- **Remove obstacles on the floor where robot cleaner operates.**

The product is unable to travel to areas which are blocked by obstacles of certain height.

- **Do not install the product in a place exposed to direct sunlight.**

Direct sunlight may cause discoloration of the product.

Adapters may cause electric shock or fire due to overheating during charging.

- **Do not install the charger on an inclined floor, and do not cause impact to the charger.**

The charger may become damaged or broken.

- **Install the charger at the location where robot cleaner can be easily found.**

If the site is in a corner or has many obstacles around it, automatic charging may not be possible.

- **Do not use the product in the room with an unattended child or an elderly person.**

A child or an elderly person can become frightened or injured.

- **Make sure that the charger is always plugged into a power source.**

If no power is supplied to the charger, you cannot use the function of robot cleaner charging after automatically returning to the charger.

In using the product

- **Do not stand or sit on the product.**

Movement of the product may cause an injury or the product can be damaged.

- **Do not use the product on a narrow and elevated space such as on a desk.**

Robot cleaner can fall off and result in a person's injury or some damage to the product.

- **Make sure that no liquid enters or falls on the product.**

The product may malfunction or can be damaged.

- **If the product happens to vacuum plastic bags or other such things, they should be immediately removed.**

If the dust intake gets clogged and the product is used for a long time with the internal motor heating, the product will be damaged.

- **Do not use the enclosed battery charger for charging of any other product.**

The charger or other products can be damaged.

- **Make sure that clothes, hair, fingers or other body parts are not caught by the wheels.**

An injury may occur.

- **Do not press the bumper of the product severely or give excessive shock.**

The bumper sensor can be damaged and then work abnormally.

- **Do not keep or use the product at too low or too high a temperature.**

Do not use the product at a temperature of -5°C or lower or 35°C or higher.

- **Do not operate robot cleaner with the dust box full.**

It can cause reduction in suction power.

- **Check if the filter is inserted into the dust box.**

If the robot gets activated with no filter, it can cause product failure.

- **Prevent the main brush and the side brush from being clogged with hairs or other foreign substances.**

It can cause noise and reduction in sucking power or damage to the product.

- **Before using the product, clear away any obstruction from the floor.**

Small dish towels, bath towels, pads, telephone lines, power cables, strings or belts can be entangled with the operating wheels or the brushes.

Make sure to remove things that can be easily broken (ceramic wares, glass cups, etc.).

- **Do not use robot cleaner on the wall or on the mirror or glass floor.**

Robot cleaner might not be able to recognize glass or a mirror as an obstacle because it uses an infra-red light sensor to detect an obstacle.

- **Avoid using the product in a utility room, in the room with a wet floor, on the stairways, on a table, on a shelf, in a storage room, in a commercial building and outdoors.**

- **If you have dropped the product or caused an impact to the product, contact the designated service center immediately.**

Electrical cautions

- **Make sure to use only the specified voltage and current.**

Power supplies outside the specification ranges may cause a serious damage to the product.

- **If Robot cleaner is stored for long time without being used, the body battery can be discharged.**

When storing the device for a long period of time, make sure to turn off Power switch on the rear.

- **Do not use a damaged power cord or plug.**

There is chance of shock and/or serious injury.

- **If the power cord of the charger is damaged, contact the service center immediately.**

- **If the supply cord is damaged, it must be replaced by the manufacturer, its service agent or similarly qualified persons in order to avoid a hazard.**

- **Make sure that the power cord is not pulled or pressed down by doors.**

The power cord can be pulled out or damaged.

- **When connecting / disconnecting the plug into / from the receptacle, make sure to do so by holding the plug part, rather than pulling on the cord.**

- **Do not touch the power cord with wet hands.**

You can get shocked.

- **If robot cleaner touches water, unplug the power plug and dry it completely before using again.**

An electric shock or a fire may occur. If water enters the product, contact the service center.

- **Use the enclosed charger only.**

The product may be damaged due to overvoltage, or a fire or electric shock may occur.

- **Do not install the charger in a place which is damp or dusty, where water splashes or where steam is emitted.**

The product may malfunction, or a shock or damage of the product may occur.

- **Do not contact any metal objects such as clip and pin to the charger terminal.**

It can cause electric shock and fire.

- **For indicator power, use rated batteries and adapters.**

If not, the product can be damaged set on fire or it may not work.

- **In case of insufficient indicator battery, replace with a new one.**

Without batteries, indicator functions may not work normally.

In product management

- **Use the standard filter only.**

No warranty service will apply to any error or failure of the product caused due to a substandard filter.

- **If cleaning the product, make sure power is off first.**

If you happen to care for the product while it is working or the power is still connected, injury is possible.

- **Clean Main Brush, Side Brush, Dust Bin, Dust Bin Filter, and Dust Suction Inlet periodically.**

If the product is used for a long time without cleaning, it can work abnormally and cause product failure.

Others

- **Do not operate the product in a site with flammable substances.**

This includes alcohol, gasoline, distilled water, thinners, ashtrays with flames, candle lights stoves.

- **Disassembling or repairing the product must be performed by a designated service center or authorized engineers only.**

Tampering with the product can lead to damage or shock.

- **Do not discard the battery carelessly.**

Putting old batteries near fire or direct sunlight for prolonged periods can cause fire and/or explosion.

Discard used-up batteries safely according to local regulations.

Danger

- **Do not place hot or flammable objects such as cigarettes, candles, heaters, matches or gasoline near product.**

The product can become badly damaged or a fire may break out.

- **Do not use the product near an explosive object or in an explosive place.**

- **This appliance is not intended for use by persons (including children) with reduced physical, sensory or mental capabilities, or lack of experience and knowledge, unless they have been given supervision or instruction concerning use of the appliance by a person responsible for their safety.**

- **Children should be supervised to ensure that they do not play with the appliance.**

Federal Communications Commission

- **This device complies with part 15 of the FCC Rules,**

- **Operation is subject to the following two Conditions :**

(1) This device may not cause harmful interference, and

(2) this device must accept any interference received, including interference that may cause undesired operation, for compliance could void the user's authority to operate the equipment.

Product composition

Basic Components



Main body



Charger



Charger sdapter



Charger adapter
power cord



Remote control &
Battery(2x AAA)



2x Side brush



Brush



Screwdriver



User manual



Quick
User Guide

Additional Components



2x Side brush



Battery(2800mA)



Dustcloth guard & 2x Dustcloth
(Not supplied with the product)



Indicator
(Not supplied with the product)



Additional accessories by model number.

- ◆ Side brush 1SET: MR6500—****B/F/G/H/L/M/N/P
- ◆ 2800mA large battery Pack: MR6500—****C/F/I/J/L/M/O/P
- ◆ Mopping Guard + Cloth: MR6500—****D/G/I/K/L/N/O/P
- ◆ Indicator: MR6500—****E/H/J/K/M/N/O/P



The appearance and specifications are subject to change without prior notice for better product functions or performance.

Cautions before using the product

※ The appearance, specifications and other parts of the product are subject to change without prior notice for product improvement.

- 01. When opening the package, be careful so that no shock applies to the product and its components.**
See Page 16 for the product installation.
- 02. Be sure to check the mounting locations (L/R) for the side brushes before installing them.**
See Page 17 for the side brushes installation method.
- 03. After removing from the product package, charge manually before operating.**
In initial opening, the battery may have become discharged and may not work. For manual charging method, see page 18.
- 04. Clear away all large debris from the floor to be cleaned.**
Clear away objects, which might break or fall, from the floor. Carpets with decorative embroidery such as long tassels, may hinder the product from moving normally. Fold the tassels or clear away the carpets.
- 05. If the dust box of the robot cleaner gets filled, and is not emptied, cleaning performance will deteriorate.**
After each cleaning operation, check if the dust box is filled up.
See Page 33 for how to clean the dust box.
- 06. Remove foreign substances from the location-detecting sensors and wheels.**
They may prevent the robot cleaner from moving or cause errors.
See Page 35 for how to clean the location-detecting sensor and wheels.
- 07. Children or the elderly may get frightened by the robot.**
To prevent children or the elderly nearby from being taken aback, make sure to explain details of product to them before operation.
- 08. Be careful that the robot cleaner does not fall from high places.**
If shoes or something similar are put side by side on the shoe shelf at the entrance of the living room, the robot might see the shoes as floor, falling from the living room. Do not use the robot cleaner in a narrow site (e.g. desks, tables, etc.) where the robot cleaner can fall.
- 09. The cleaner is not able to cross over a threshold higher than 1 cm.**
- 10. When storing the robot cleaner that is completely charged, leave it docked to the charger or turn off the power from rear part of the body.**
- 11. In case of storing the robot cleaner after its charging is completed, leave it docked on the charger or turn off Power switch located at the bottom of the rear side.**

Name of each part of the product

Robot cleaner(Top)

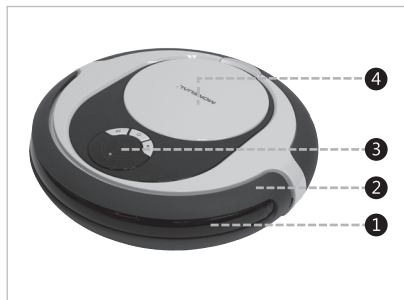

- ① Obstacle- and signal-detecting sensor
- ② Bumper
- ③ Control buttons and operation lamps
- ④ Dust box cover

Control buttons and operation lamps

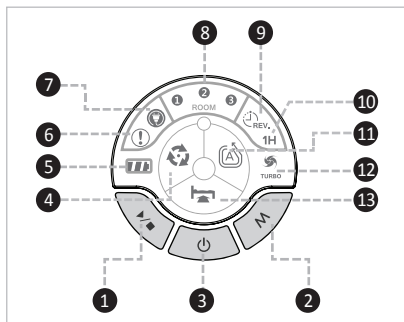

- ① Start/Stop Button
- ② Mode Setup Button
- ③ Power On/Off Button
- ④ Focused Cleaning Indicator
- ⑤ Battery Lamp
- ⑥ System Error Lamp
- ⑦ Charging Mode Indicator
- ⑧ Room Setup Indicator
- ⑨ Daily Reservation Indicator
- ⑩ 1-hour reservation setting indicator
- ⑪ Automatic Cleaning Mode Indicator
- ⑫ Suction input turbo indicator
- ⑬ Shadow Cleaning Mode Indicator

Robot cleaner(Rear)



- ① Dust box
- ② Air outlet
- ③ Power switch
- ④ Signal Receiver

Robot cleaner(Bottom)

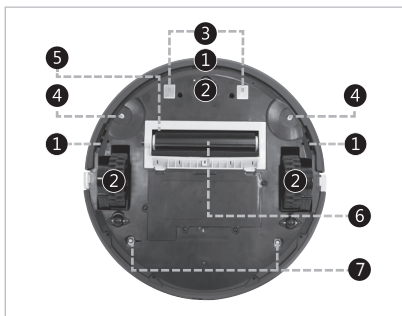

- ① Location—detecting sensor
- ② Wheels
- ③ Charging terminal
- ④ Side brush mounting pin
- ⑤ Dust intake
- ⑥ Main brush
- ⑦ Dustcloth guard mounting hole

Indicator(Top)

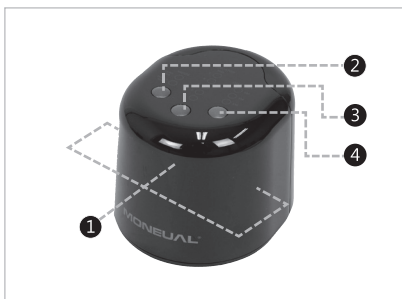

- ① Signal transmission sensor
- ② Mode switch button
- ③ Distance setup button
- ④ Indicator number setup button

Indicator(Bottom/Rear)



- ① Battery cover
- ② Power button
- ③ Adaptor jack

Charger(Front)



- ① Operation lamp
- ② Guide signal transmission sensor
- ③ Charging terminal

Charger(Rear)



- ① Adapter jack
- ② Adapter compartment
- ③ Sensor Signal Distance Adjustment Switch.

Installing the Product

01. Plug the adapter power cord into the adapter and connect to power outlet.

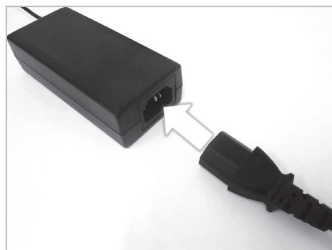

02. Connect the charger adapter with the charger.

- Once the power is connected, the blue lamp will turn on at the front.
- For appropriate charging of the product, the charger adapter should be connected with the power at all times.



03. Arrange the position of the charger.

- The charger should be placed in a location free of obstruction with at least 1m of space on all sides.
- The wall facing the rear of the charger should not be made of glass or glossy materials.
- Insert the adapter into the compartment of the charger, properly.
- If the charger is installed in a site under direct sunlight, automatic charging may not occur or the product can become discolored.

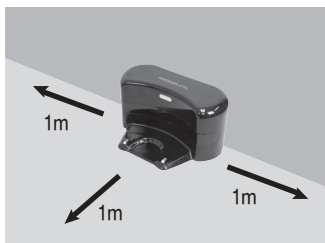

Considering location of the charger and size of the house, set the Sensor Signal Distance Adjustment switch as 5m to 8m to adjust the signal detecting distance of the robot cleaner.



If the robot cleaner fails to return to the charger, switch the distance setup located on the rear part of the main body.

- ◆ If the charger is installed in a narrow space, select 5M. If installed in a large space, select 8M.
- ◆ If the charger is installed in a narrow space and 8M is selected, automatic charging may not work properly.
- ◆ Do not place the indicator on the charger. Signal inference may occur to disrupt automatic charging.

04. Install the side brushes.

- Use the side brushes, screws and driver included in the box to install side brushes onto the underside of the main body.
- Install the L-side brush to the “L” position and R-side brush to the “R” position.

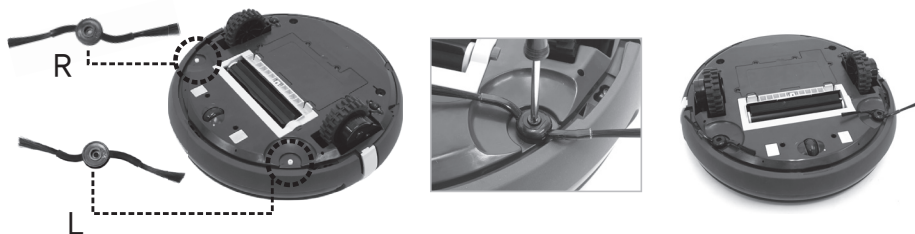

05. Attach the dust cloth guard onto the robot cleaner.

- If you do not want to use the dust cloth function, skip this step and go to the next procedure.



Mopping guard and cloth are included in certain models.

06. Turn on the power switch of the robot cleaner (at the left of the rear dust box).

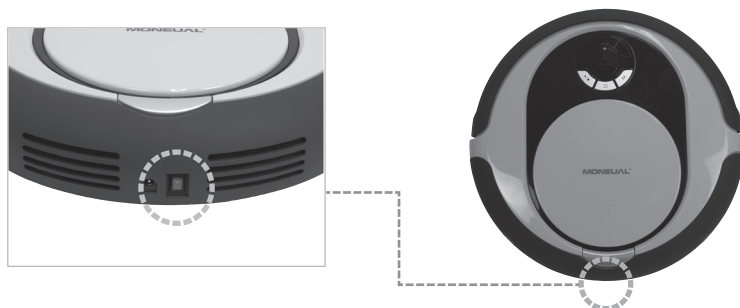

07. Place the robot cleaner in the charger with both hands to start charging.

- Locate the robot cleaner and the charging terminal of the charger in contact.
- When the robot cleaner is charged for the first time, it may take one (1) hour for the robot cleaner to complete charging. (2 hours cleaning time with 2800mA battery pack)
- After 1-hour charging, you can use the product for around one (1) hour with medium suction power. (The operating hour may vary depending on the usage conditions).

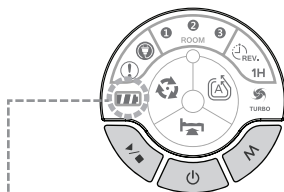

Battery lamp	Charging	Blinks 1 time/sec
	Charging completed	Charging Completed
	Low battery	Blinks 4 times/sec

08. Insert batteries in the remote controller and the indicator.

- Install batteries according to the correct polarity.

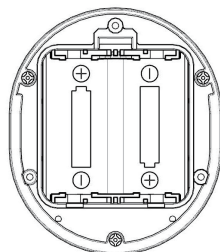
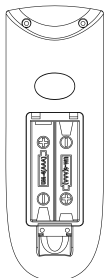

Indicator is included in certain models.

If the battery is inserted with the polarity reversed, be careful because the remote control and the indicator may be damaged or cause a fire.

09. Install indicator in the desired position.

- The product is fully capable of cleaning, functions even without an indicator installed.
- For detailed installation methods, see page 36.



It is possible to use a separate adaptor (5V). (If an adaptor is used, the cleaner does not use the battery.)

If the adaptor whose output is more than 5V is connected, be careful because the indicator may be damaged.

If the adaptor for the charger (18VDC) is connected, do not connect it because the indicator may be damaged.

Descriptions for remote controller buttons

Use various functions conveniently with the remote controller.



Functions available with the main body of the robot cleaner

Automatic cleaning, shadow cleaning, focused cleaning, charging



Functions available with the remote controller

Automatic cleaning, shadow cleaning, focused cleaning, corner cleaning, manual cleaning, charging, suction control, reservation setting, room selection, mute, manual movement



① POWER button

- Turns power on/off
- If the product operation gets stopped due to errors, the button makes the product go back to the operation mode

② MODE button

- Select the cleaning mode

③ START/STOP button

- Starts selected operation
- Stops current cleaning

④ OK button

- Acts as the [OK] button for various setup modes

⑤ DIRECTION buttons

- In manual cleaning, moves the product forward and backward and make the product rotate in the left and right directions
- Selects setting values in setup of time and reservation

⑥ CHARGE button

- Moves the robot cleaner with the charger

⑦ VACUUM Button

- Adjusts the strength of dust inhalation

⑧ INTENSIVE Button

- Selects the focused cleaning (See the page 23.)

⑨ AUTO Button

- Selects the automatic cleaning or the basic cleaning mode

⑩ SHADOW button

- Selects cleaning under the bed (See the page 23.)

⑪ MANUAL Button

- Used for manual cleaning operation (See the page 28.)

⑫ CORNER CL. button

- Selects corner cleaning (See the page 22.)

⑬ MUTE button

- Turns on/off operation announcement tone

⑭ ROOM SEL. Button

- Makes the product select a room and move there (See the page 26.)

⑮ RESERVE Button

- Used to make reservation setup (See the page 33.)



⑯ MS(motion control) Button

- Press this button to use the remote controller as motion-controlling tool (See the page 29.)

Basic cleaning(Automatic Cleaning)

- Basic cleaning mode.
- Without the indicator installed, the robot cleaner will just clean all open spaces.
With the indicator installed, the robot cleaner detects the signal from the indicator and will clean the room where the signal is detected. (See the pages 28 – 31.)
- While cleaning, if charging is needed, the robot cleaner will stop cleaning and move to the charger.
- After each cleaning, empty the dust box. If the dust box remains full, the suction power may deteriorate.
- Cleaning efficiency and time may vary depending on the condition of obstacles such as carpets etc on the floor.

01. Turn the power of the main body on.

Main body button	Remote controller button
	

02. Press the [START/STOP] button.

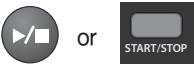
Main body button	Remote controller button
	



- If you press the [Start/Stop] button after the product starts working, it stops cleaning.
- When the cleaning is stopped and you press the [Start/Stop] button, the product will resume cleaning.
At this time, the previous cleaning operation will be ignored and the automatic cleaning will be newly activated.

03. Automatic cleaning begins.

- When automatic cleaning starts, the focused cleaning mode is on. If a certain period of time passes or an obstacle is detected, the focused cleaning mode will turn off and the robot cleaner will start moving in straight.
- The robot cleaner may occasionally move along the wall and perform focused cleaning.



When dustcloth guard is installed to the bottom part of the robot cleaner, it is automatically switched to the dustcloth cleaning mode. In this mode, the robot cleaner does not go to the carpet, foothold or threshold.

Using advanced cleaning functions



It is possible to select and clean the space that is not easy to clean through automatic cleaning.



For corners and some spots where the robot cleaner cannot go, the product will not be able to clean completely.



Before using the advanced cleaning functions:

- ◆ You cannot select a different cleaning mode while the robot cleaner is cleaning or being charged.
- ◆ In this case, you need to press the [Start/Stop] button to stop current operation and then select a cleaning mode.

Focused cleaning

From the current position, the robot cleaner performs focused cleaning over the 1 m-radius area.



- ◆ If the site has many obstacles around it, the cleaning may not be successful due to interference from them.
- ◆ When the focused cleaning mode is expanded and an obstacle is detected, it is not switched to the downsized mode.

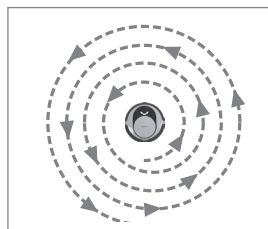

01. Select the focused cleaning mode.

- The main body shows the [Focused cleaning] indication.

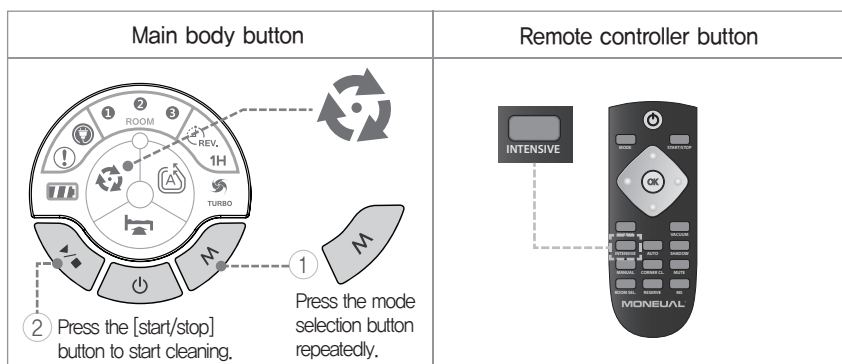

02. Press the [START/STOP] button.

- After cleaning is completed, the robot cleaner stops at its current place.
On the remote controller, press the focused cleaning button to start cleaning immediately.

Cleaning corners

The robot cleaner performs cleaning by following the wall of a current room. When the robot cleaner makes a full circle or detects the same signal from the charger, it will stop cleaning.

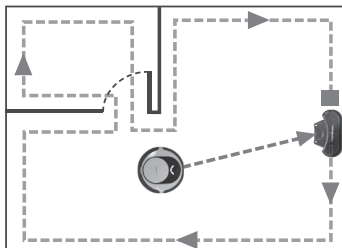

01. Press the corner button to start corner cleaning to immediately.

- After cleaning is completed, the robot cleaner will return to the charger.

Main body button	Remote controller button
(None)	

Shadow cleaning

It is possible to clean the spaces such as under a bed or furniture intensively.

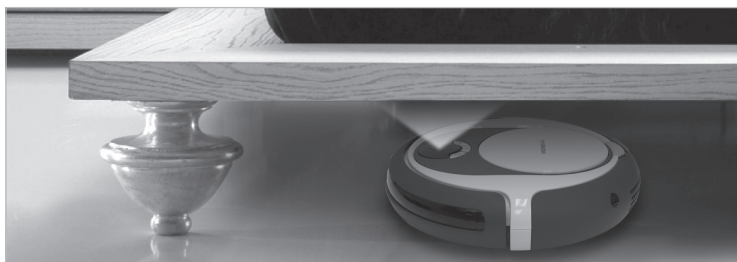

Use the product in this mode with the room light turned on. In a dark room, the product will not be able to recognize the space under the bed.



In a dark room, the product may see the entire space as space under the bed.

01. Place the robot cleaner under the bed.

- Product may not perform shadow cleaning correctly under direct light.
- If the robot is not under a piece of furniture, it will move there before starting shadow cleaning.

To reduce the moving time, place the robot cleaner in front of desired furniture before it starts working.

02. Select the mode for cleaning under the bed.

Main body button	Remote controller button
<p>② Press the [start/stop] button to start cleaning.</p> <p>① Press the mode selection button repeatedly.</p>	<p>SHADOW</p>

03. After cleaning is completed, the robot cleaner will return to the charger.

Selecting a room for cleaning

The cleaner moves to the room with the indicator installed and clean it. It is possible to purchase additional indicators and install up to 5 indicators. The cleaner operates only if the indicator for distinguishing rooms is installed. (See the page 28–31).



Indicator is included in certain models.

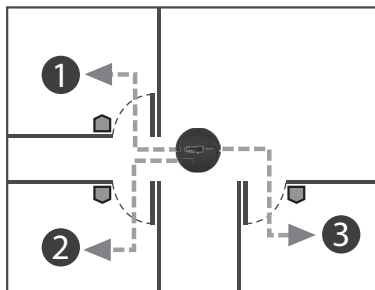

01. Select a room number.

- The main body screen will indicate the room number.
- If all room number lamps are turned off, it means no status has been selected (No selection status).
- In the no selection status, the product will perform cleaning in the same method as automatic cleaning.
- Though the Robot cleaner can detect up to three rooms, if rooms 4 and 5 are detected during cleaning, they will be cleaned separately.

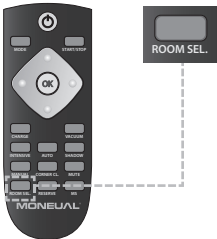
Main body button	Remote controller button
(None)	<p>Every time you press the button, the number/status will be changed among 1–2–3–4–5–no selection.</p> 

02. Press the [START/STOP] button.

- After the cleaning is completed, the product will move to the charger.

Mop cleaning



Mopping guard and cloth are included in certain models.

The dustcloth guard and dustcloth are not supplied in the product, so the user should purchase them separately.

With the dust cloth attached, the cleaner is able to mop clean the floor.

When the dust cloth guard is installed to the bottom part of the robot cleaner, it is automatically onto carpeted areas or thresholds.

switched to the dust cloth cleaning mode. In this mode, the robot cleaner does not go,

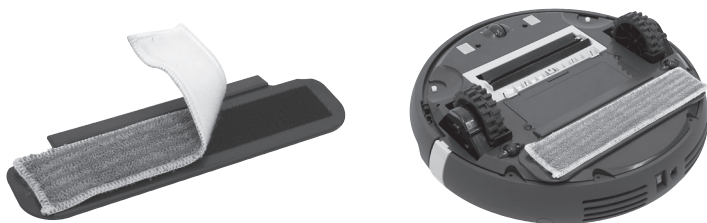

01. Put a mop made of superfine fibers onto the mop guard.

02. Install the mop guard to meet the mounting hole seen at the bottom of the main body.

03. Press the [Start/Stop] button.

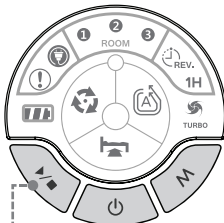
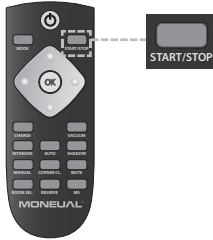
Main body button	Remote controller button
 <p>Press the [start/stop] button to start cleaning.</p>	

Cleaning in manual control mode

You can choose to manually operate the robot cleaner.

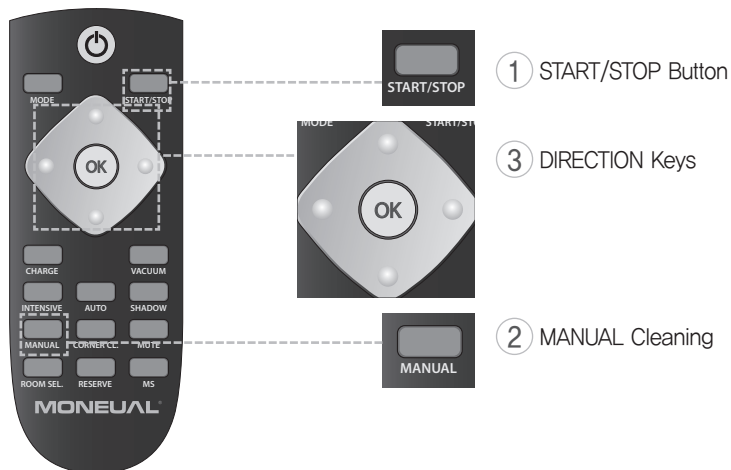

01. Press the [START/STOP] button to stop the robot cleaner if it is in operation.

02. Press the [OK/MANUAL] button on the remote controller.

- For cleaning, the product starts vacuuming at the site.
- When you press the [OK/MANUAL] one more time, vacuuming will stop.

03. Operate the robot cleaner as you like with the direction keys of the remote controller.

- Manual control is not available while charging.



If you only need a manual move, without vacuuming, this function is useful.

Cleaning through manual control 2(control of the motion)

When you use the motion control function of the remote controller, you can manually control the robot in a convenient way.

01. If the main power switch of the robot is turned off, turn it on.
02. Press the [START/STOP] button if the robot is in operation.
03. Press the button seen below to change the remote controller operation mode for the motion control mode.



If no operations are detected for five (5) or longer seconds during motion control, the motion control mode will be released.



04. Use the motion shown in the figure below to manually control the robot.



[Turning on/off the power – [POWER] button from the remote controller]

Quickly flick the front of the remote controller upward.

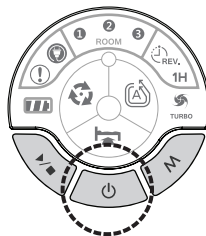

[Turning on/off cleaning mode – [OK/MANUAL] button from the remote controller]

Slightly flick the remote controller toward left/right. The inhalation motor will start/stop working.

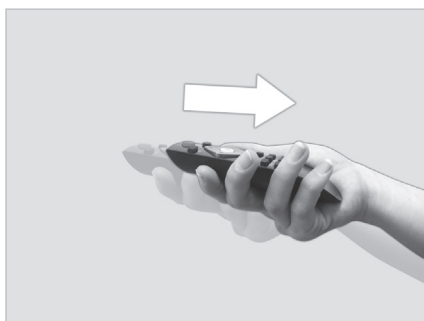

[Adjusting the sucking power – [VACUUM] button from the remote controller]

Slightly pull the remote controller following the arrow.



[Moving the robot straightly to the fore/back direction – [UP/DOWN] button from the remote controller]

Bend the fore part of the remote controller downward or pull it upward.



(Forward move)

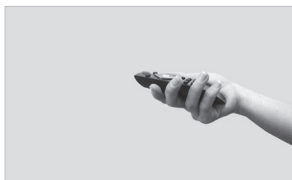

(Stop)

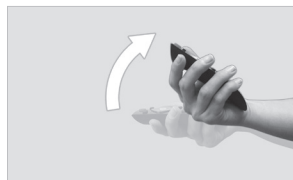

(Backward move)



[Controlling the rotation – [LEFT/RIGHT] button from the remote controller]

Turn the remote controller to the left/right.



(Turning counterclockwise)



(Stop the rotation)



(Turning clockwise)



05. To release the remote controller from the motion control mode, press the motion control conversion key again.

Setup of time and reservation

Setting Reservation Mode

Starts cleaning in an hour or at the same time every day.



- ◆ Before making a reservation, be sure to install the charger.
- ◆ The reservation is available only with the remote controller.
- ◆ If the battery is being charged at a reserved time, the reservation cleaning will be executed after the charging is completed.
- ◆ If robot cleaner is set to '1 hour' reservation, it completes 1 cleaning cycle at the reserved time and then the reservation setting is initialized.
- ◆ If the robot cleaner is working, press the [Start/Stop] button to stop it before proceeding.

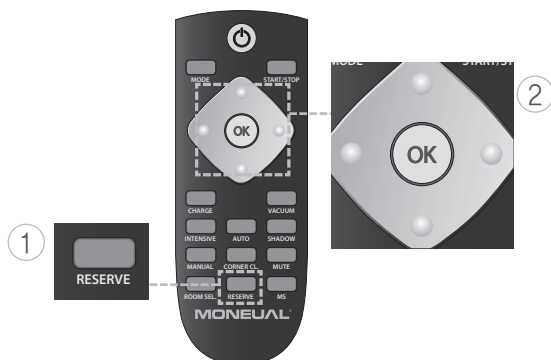

01. Press the [Reservation] button.

- Whenever the [Reservation] button is pressed, hour/daily lamps will turn on. If all reservation-indicating lamps are turned off, it indicates the status that the user selected nothing.

02. Press the [SELECT] button.

- Select the reservation time and press the [OK] button to finish reservation.

03. When the reservation is made, the robot cleaner returns to the charger and starts cleaning automatically after the reserved time passes.

- If every day is selected, cleaning will start at the same time every day.

Using the indicator

The indicator enables you to separate spaces into different zones within your home. Using the room assortment mode or setting a cleaning area enables you to make good use of the indicators.



Indicator is included in certain models.



Check the indicator battery status.

- Press any button to check if the lamp blinks; if so, it means the indicator is turned on.
- If the battery becomes depleted, press the button; all the lamps will blink at the same time. In this case, you need to replace the battery.
- If you do not want to use the indicator, turn off the power switch in the rear to conserve battery.

Using the product for the room assortment mode

01. Place the indicator against a wall on the floor at the entrance of a room.

- If the indicator is put at a place 10cm or higher than the floor, the robot cleaner may fail to identify it.
- In general, you can install the indicator at the position marked with the symbol () seen in the figure below.
- Up to three (3) indicators can be installed.
- If there is a door where the indicator is installed, leave the door open so the robot has access to the room.

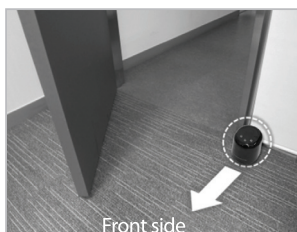
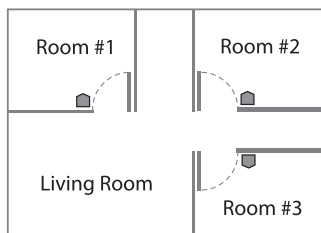

02. Press the [Mode] button to set the product into [Indicator] mode.

- When the lamp turns on, repeatedly press the button until the [Indicator] lamp gets turned on.

03. Press the [Distance] button to set a door width.

- Repeat pressing until the setup is made for the door width.
1m(●) – 3m(●●) – 5m(●●●)
- For the average home, 1m setup is adequate.
- If the distance is set too excessively, the robot cleaner may not function correctly.

04. Press [INDICATOR NO.] on the indicator to set the room number.

- Each time you press the button, the lamp turns on 1 → 2 → 3 → 4 and → 5.
- The INDICATOR NO that allows MR6500 to select the room for cleaning is “1 ~ 3” .
- If two or more indicators are installed, INDICATOR NO should not be duplicated.



05. Leave the door open.

- If you do not want to clean the room with the indicator installed, close the door.

Using thorough setup of cleaning areas

- You can make the robot cleaner work only within a specified space (gray area in the figure).
- In addition to the example below, you can make other spaces in various forms.
- Indicator signals are transmitted into three front/right/left directions.

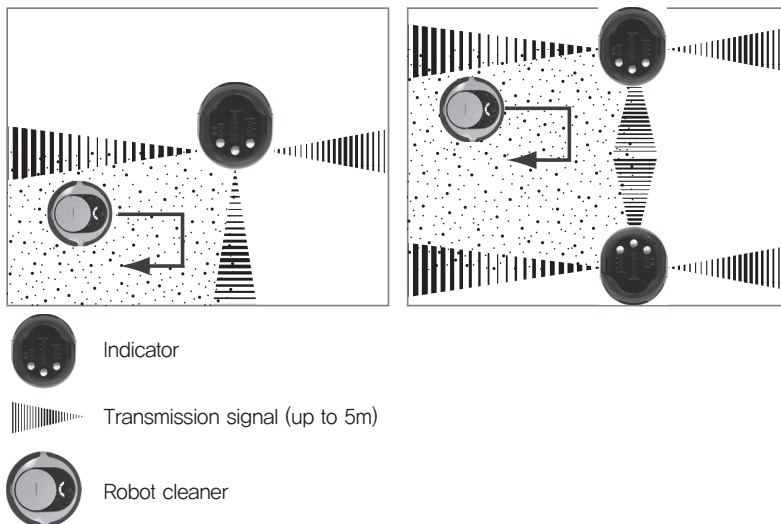

01. Press [MODE] on the indicator to change the mode to [CLEAN AREA].

- When the lamp gets turned on, repeatedly press the button until the [Set cleaning areas] lamp is turned on.

02. Press [DISTANCE] and then adjust the distance of the cleaning area setting signal.

- Repeat the pressing of the button until the distance of signals to set cleaning areas is set at the desired level, 1m(●) – 3m(●●) – 5m(●●●)
- If the distance is set as too short or too long, the robot cleaner may not properly understand the area.

03. Calculate the signal distance to arrange the indicator in the appropriate position.

- If the signal does not reach the wall, the robot cleaner may slip through the crack.



If the emitting signals of each indicator get overlapped, no setup for cleaning area will be made.

In this case, it will become as if no indicator were installed.

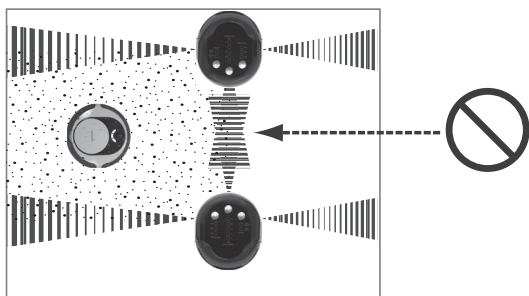

It is recommended that you not install indicators in a place with the charger in it. The emitting signals of the charger (in the radius of 8 meters) may be overlapped with the signals of indicators, which can be ignored.

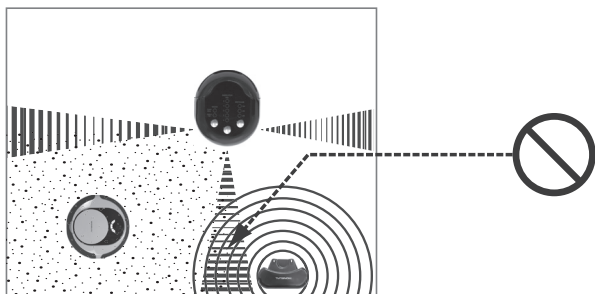

Charger



Emitting signals of the charger

Managing the product

Language Selection



If the robot cleaner is operating, press the [Start/Stop] button and the [Power] button to turn it off before proceeding.

- You can select the language for the voice announcements spoken by the robot.
- Voice announcements in foreign languages may not be provided depending on where the product is sold.

01. Turn off the power switch located at the side of the main body.
02. While pressing the mode button on the upper part of the main body, turn on the power switch at the rear part of the robot cleaner to enter into the language selection mode.

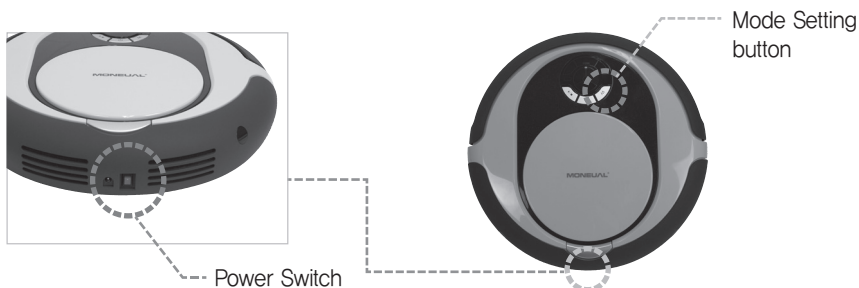

03. Press [Start/Stop] button to select the country number.

- Voice announcements below are played in selected language.

"Start automatic cleaning."

"The cleaning is cancelled."

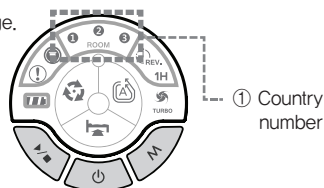

04. Languages changed by [Start/Stop] button may differ depending on the product and the region it is sold in.

No.	Language
1	English
2	Germany
3	French
4	Korean
5	Chinese
6	Japanese

05. Press the power button at the upper part of the main body to complete language setting in the selected language.

Cleaning the dust box

01. Press the lever to lift the cover of the dust box.



02. Pull out the dust box.



03. Remove the dust filter.

- The dust filter can be water-cleaned. After cleaning the filter with water, let air dry.
- In water-cleaning the filter, do not use any detergent.

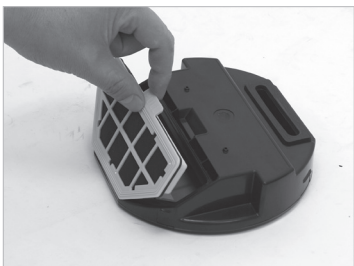

04. Empty the dust box.

05. Insert the filter back into the dust box.

- If the filter is water-cleaned, wait until it is completely dry before inserting it in.

06. Insert the dust box.

- Insert the dust box to the robot cleaner.



07. Replace the dust box cover.

- Press the dust box cover until it clicks.



Replacing the filter

- To reuse the filter, you need to water-clean it after removing it from the dust box.



Do not use any detergent; use only water to clean it.

- For removal of the filter, refer to Step 3 in the "Cleaning the dust box" section.

The life span of the filter is around six (6) months and can decrease depending on usage environment. Any end-of-life filter will show a decrease in performance

Cleaning the Sensor

Clean or dust the three (3) sensors as indicated in the figure with a brush or cotton swab.

- If contamination is severe, clean it with the wet swab.
- Do not directly apply water, benzene or alcohol to the sensors.



Cleaning Wheels

Clean the wheels with a brush.

- Turn each wheel while cleaning to clean the entire wheel.
- Remove hairs and other foreign substances, which can disturb operation of the wheels.



Cleaning the Dust Inlet

01. Remove the dust inlet cover.



02. Remove the main brush by holding and lifting it.



03. Clean the removed main brush with a cleaning brush.

04. Insert the main brush back.

- Check the groove shape and insert it into the fixing hole of the rubber brush. Then, fix the wing of the fixing pin to the fixing pin.



05. Insert the dust inlet cover.

- Insert the protruding part first. Press the opposite side until the fixing pin is fully installed.



Battery usage and management

Batteries are consumables. The longer they are used, the shorter the usage time becomes.

Life span of the battery

- We guarantee twelve (12) months battery life in general usage environments.
- For ideal battery use, make sure that it is always charged.
- The life span of the battery can vary depending on the usage environments.

Usage time of the battery

- Before you use the robot cleaner for the first time, manually charge it completely.
- It may take one (1) hour for the robot cleaner for complete charging.
(Two (2) hours for the 2800mA battery which can be purchased separately)
- After charging is complete, the robot cleaner can operate for around one (1) hour in medium suction power. (One hour and 40 minutes for the 2800mA battery which can be purchased separately)
- In more complex or dirtier environments, cleaning operation time on one charge may decrease.
- If the robot cleaner is left with its power on and is not connected to the charger, its operating time can decrease or battery can become fully discharged.

Replacing the battery

- Once the cleaning operation time gets considerably shortened, you will need to replace the battery.
- Make sure to use factory standard batteries.
- To purchase an additional battery, contact the RYDIS Customer Service Center.

Replacing the battery

If you feel it is too difficult to manually replace the battery, please contact customer center.

01. Press the [Power] button to turn off the robot cleaner.
02. Loosen the four screws of the battery cover and lift it off.

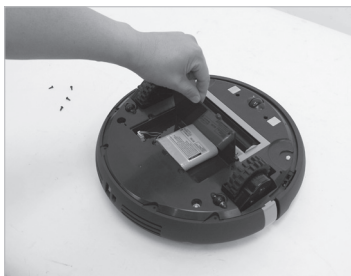

03. Pull out the battery pin and remove the battery.

- Press the lock at the same time to pull out the battery pin.

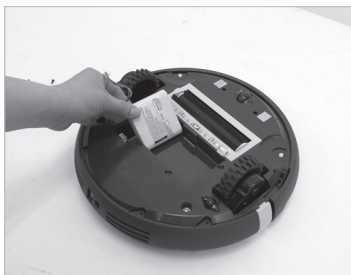
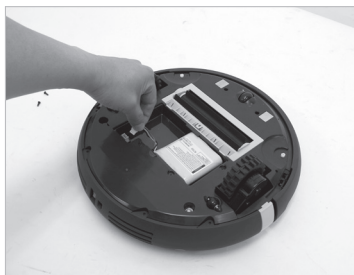

04. Replace with the new battery and insert the battery pin.



05. Close the battery cover and tighten the screws.

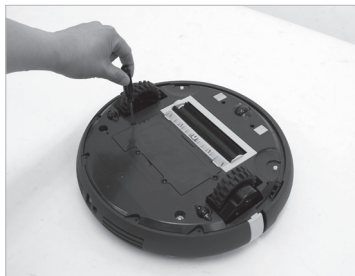

| How to Extend Battery Life

- If planning on not using the battery for a long time, charge it completely, then separate the battery from the main body before storing it.
- Clean the dust intake and the dust box frequently.
If you use the product while it is filled with foreign substances and dust, it can cause increase in rotation of internal motors and shorten the life span of the battery.
- Charge the battery between each use of the product.
- In charging or long-term storage, keep the product away from direct sunlight and fire.

Voice announcement list

The list below shows basic voice announcements, which is subject to change depending on user specification.

Voice announcement functions	
Start the automatic cleaning.	The automatic cleaning function is launched.
Start the corner cleaning.	The corner-cleaning operation is launched.
Start the focused cleaning.	The focused cleaning operation is launched.
Start reserved cleaning.	The reserved cleaning operation is launched.
Start the cleaning under the bed.	The cleaning under the bed operation is launched.
The cleaning is completed.	The cleaning operation is completed.
The cleaning is cancelled.	The Stop button is pressed during cleaning.
Move to the charger.	The [Charging] button of the remote controller is pressed or the product is moving to charger for automatic charging.
Start the charging.	The charging has begun.
Move to the indicator No. X.	The product has started moving to clean a specified room.
Reservation is made	The reservation is made

Check the message function	
The battery is discharged.	The battery is discharged.
There is no dust box inserted.	The dust box has been removed.
Put the product on the floor.	The robot cleaner is lifted from the floor.
Check the wheel.	The wheel is jammed.
Check the main brush.	The main brush is tangled or jammed in a foreign substance.
Check the side brush.	The side brush is tangled or jammed in a foreign substance.
Errors are generated.	Errors have occurred (See the error code chart).

System Check Code List











If the product stops working with error codes displayed, you can resume operation by pressing the [POWER] button.







If the problem persists even after the following steps are taken, contact our customer service center.



The audio announcement for faulty situations will be played only one time.

ROOM 1 	Cause	The battery is discharged and the robot cleaner cannot work.
	Action	Manually charge the robot cleaner.
ROOM 1 	Cause	Either one or both wheels are overloaded.
	Action	Relocate the robot cleaner. Remove foreign substances from wheels.
ROOM 1 	Cause	The air intake pan is overloaded.
	Action	Remove foreign substances from the dust intake and empty the dust box.
ROOM 1 	Cause	The main brush is overloaded.
	Action	Remove foreign substances (hair, etc) from the main brush.
ROOM 2 	Cause	The robot cleaner is charged without the battery.
	Action	Check if the battery is installed.
ROOM 2 	Cause	Battery failure
	Action	Please contact our service center.
ROOM 2 	Cause	Attempt to run the robot cleaner without the dust box.
	Action	Install the dust box.
ROOM 2 	Cause	Both wheels are lifted.
	Action	Place the robot cleaner on the floor or lift it to another site.

ROOM 3 	Cause	The escape vent has exceeded tolerance level.
	Action	Remove foreign substances from the front caster and empty the dust box.
ROOM 3 	Cause	The bumper keeps impacting and disrupting cleaning.
	Action	Remove foreign substances from the bumper. Check if the bumper is properly installed.
ROOM 3 	Cause	The fall warning keeps activating and disrupting cleaning.
	Action	If the floor is black, relocate the robot cleaner.
ROOM 3 	Cause	Others
	Action	Please contact our service center for unknown other errors.

Checkpoints before request for after-sales service

Error details	Checkpoints and actions to be taken
Q. The robot does not work.	(1) Turn on power switch at the rear of robot. (2) Check if the battery is discharged. → Charge the robot with the charger.
Q. The robot cannot be charged.	(1) Clear away obstacles from the charger. (2) Check if the charger is turned on. (3) Turn on the power switch at the right bottom of the rear part. → If you force the robot to be charged, it may not work.
Q. The remote controller does not work.	(1) Try remote synchronization. (2) Change the battery of the remote controller.
Q. The suction power is too weak.	(1) Empty the dust box. (2) Clean the filter of the dust box. (3) Check if there are foreign substances in the intake.
Q. The robot cannot be turned on.	(1) Turn on power switch on the rear of the robot. (2) Check if the battery is discharged.
Q. The brush does not rotate.	(1) Check if there are any foreign substances around the brush. (2) Check if the brush is properly inserted.
Q. The noise level is louder than before.	(1) Check if the filter of the dust box is properly inserted. (2) Check if there are any foreign substances around the brush.
Q. The robot works abnormally during cleaning.	(1) Check if the dust cloth is inserted (if is purchased separately) and then if it is appropriately inserted. (2) Clean the sensor and the adjacent part with a soft cloth.
Q. Reserved cleaning mode won't set.	Press the [SELECT] button when the reservation is made.
Q. The robot does not respond to any button.	If the main body is directly connected with the adapter for charging, no button input will work during manual charging.
Q. The operating time is short	(1) If the robot cleaner is left for a long time while it is not connected to the charger properly or the rear adapter is not connected, the battery can be discharged and operating time shortened. (2) Even when the robot cleaner is fully charged, keep it connected to the charger. (3) If you want to store the robot cleaner for a long time, turn off power switch at the rear before storing.

Product specifications

Robot cleaner

Model	RYDIS MR6550
Dimension	Diameter 347 mm X Height 82 mm
Weight	2.674kg
Max. Speed	Cleaning Mode: 25cm/sec.; Moving Mode: 20cm/sec.
Operating Noise	Maximum 60dB (2800mA Battery, Maximum 70dB)
Power Consumption	Maximum 20W (2800mA Battery, Maximum 25W)
Battery	LiFePo4, 12.8V DC
Capacity of the Dust Box	600 ml
Charging Time	Around 60 min. (2800mA Battery, 120 min.)
Operating Time	Typical suction power: Normal: 60 min. and turbo: 40 min. (2800mA Battery, Normal: 100 min. and turbo: 70 min)



This wireless system can cause interference of radio waves so that it is not available for services related to safety for human life.

- Company name: Moneual, Inc.
- Product name: Specific small-output wireless device
- Authentication No.: KCC-REM-MOL-RYDISMR6550

Charger

Model	MRD6500
Dimension	Length 264 mm X Height 179 mm X Width 134 mm
Weight	606 g
Input voltage	100~240V
Output voltage	18V DC
Signal transmission distance (IR)	5m / 8m



- Company name: Moneual, Inc
- Device: Electromagnetic compatible device
- Certification No.: KCC-REM-MOL-MRD6500

※ The output distance for each signal can vary depending on adjacent environments and the remaining battery capacity.

Indicator

Model	MRI6500
Dimension	Length 100 mm X Height 116 mm X Width 88 mm
Weight	247 g
Battery	2 X D type
Battery operation time	Approx. six (6) months (Standby mode)
Signal transmission distance (IR)	1 ~ 5 m



- Company name: Moneual, Inc
- Device: Electromagnetic compatible device
- Certification No.: KCC-REM-MOL-MRI6500

Remote controller

Model	RC-750
Dimension	132.7 x 23.4 x 46.9mm (LxHxW)
Weight	0.06kg
Power source	AAA alkaline batteries (LR03) ; 2EA
Battery life	6 months
Signal transmission distance (IR)	10m

This wireless system can cause interference of radio waves, and so, it is not available for services related to safety for human life.

- Company name: Moneual, Inc.
- Product name: Wireless device for wireless data communication systems
- Authentication No.: MOL-RC750



PRODUCT WARRANTY

The warranty period for the product and the battery is one (1) year.

We, Moneual, offer the following warranty service to our consumers based on the customer compensation regulation. By the request for the warranty service, DAEWOO Elec Service Co., Ltd. will provide the service. The company will notify the customer of compensation details within seven (7) business days after the requested day and offer the compensation within fourteen (14) business days after the notified day. We do not offer any paid/unpaid service for parallel imports.

Product name		Model name	
Purchased date	month date, year	Serial No.	
Dealer		Price	

UNPAID SERVICE

※ If products for general users are used for sale purpose, unpaid service may not be offered.

Type of damages to customers			Compensation details	
			Within the warranty period	After the warranty period
Malfunctions in performance and functions during normal use within the period when related parts are being stored	Essential repairing is required within ten (10) days after the purchase,		Replace the product with a new one or refund the product at the purchased price,	Not applicable
	Essential repairing is required within one (1) month after the purchase,		Replace the product with a new one or offer unpaid repairing,	
	A replaced product gets faulty, requiring essential repairing within one (1) month after the replacement,		Refund the product at the purchased price,	
	No replacement is available,			
	Repairing is available,	Malfunctions are generated for three (3) times due to the same defects,	Unpaid repairing	Paid repairing
		Malfunctions are generated for four (4) times due to the same defects,	Replace the product with a new one,	Paid repairing
		Malfunctions are generated for five (5) times due to different defects,		Paid repairing
	The repairing company has lost the product requested for repairing by the customer,		Replace the product with a new one or refund the product at the purchased price,	Refund the product at the fixed depreciated price added with 10% of the fixed depreciated amount,
	Repairing is NOT available as no parts for repairing are put in stock within the period when related parts should be stored,			Refund the product after the fixed depreciation,
	Repairing is NOT available although parts for repairing are stored,			Replace the product by applying fixed depreciation, after the expenses for paid repairing is paid,
Malfunctions caused from intension or negligence of customers	Repairing is NOT available,		Replace the product after the amount corresponding to the expenses for paid repairing is paid,	
	Repairing is available,		Paid repairing	Paid repairing

PAID SERVICE

※ If you ask for the after-sales service and the product is not found faulty, you will be responsible for the service fee.

Therefore, please read through the Users' manual before contacting the service center.

Cases when the product is not faulty

- Users ask for the after-sales service before fully understanding the Users' manual.
- Problems in external environments including propagation of radio waves and wired signals
- Errors in initial installation for the supplied product
- Treatment of the filter and removal of foreign substances from accessories
- Malfunctions caused from other companies' products (including software)

Malfunctions due to customers' negligence

- Malfunctions caused from wrong power capacity
- Malfunctions caused from external shock or fall
- Malfunctions due to use of consumables or optional devices not specified by our company
- Malfunctions caused from the repairing person, who is not from our partner companies specified by our company
- Malfunctions caused from ignorance of "Cautions for safety" described in the Users' manual

Other cases

- Malfunctions caused from natural disasters (Lightning, fire, salt damage and water damage)
- The life of consumables comes to an end.

MONEUAL

www.moneual.com

Robot cleaner RYDIS MR6550

Copyright © 2012 MONEUAL Inc. All rights reserved. The MONEUAL, MONCASO, MiNEW, RYDIS, SONAMU are trademarks, or registered trademarks of MONEUAL Inc. in the Republic of Korea and/or other countries.

MONEUAL®

FCC INFORMATION

This device complies with Part 15 of the FCC Rules. Operation is subject to the following two conditions:

1. This device may not cause harmful interference, and 2. This device must accept any interference received, including interference that may cause undesired operation.

Note: This equipment has been tested and found to comply with the limits for a Class B digital device, pursuant to part 15 of the FCC Rules. These limits are designed to provide reasonable protection against harmful interference in a residential installation. This equipment generates, uses and can radiate radio frequency energy and, if not installed and used in accordance with the instructions, may cause harmful interference to radio communications. However, there is no guarantee that interference will not occur in a particular installation. If this equipment does cause harmful interference to radio or television reception, which can be determined by turning the equipment off and on, the user is encouraged to try to correct the interference by one or more of the following measures:

- Reorient or relocate the receiving antenna.
- Increase the separation between the equipment and receiver.
- Connect the equipment into an outlet on a circuit different from that to which the receiver is connected.
- Consult the dealer or an experienced radio/TV technician for help.

Caution: Any changes or modifications not expressly approved by the party responsible for compliance could void the user's authority to operate this equipment.